



baja designs®
THE SCIENTISTS OF LIGHTING

Toyota, Tacoma (05-On), 4Runner (09-On) S2 Wide Reverse Kit Instructions



185 Bosstick Boulevard • San Marcos • CA • 92069

Phone 760-560-2252 x3 • Fax 760-560-0383

info@bajadesigns.com • www.bajadesigns.com



baja designs®
THE SCIENTISTS OF LIGHTING

LIMITED LIFETIME WARRANTY

Baja Designs proudly offers a LIFETIME WARRANTY against manufacturer's defect on all the products that we manufacture.

These are comprehensive warranties; other than the exclusions below – you're covered. If your LED or HID bulb burns out, you're covered. Additionally, cutting off our connector or changing your lenses does not automatically void your warranty.

Exclusions:

Installation errors, abuse, misuse or crash damage. You must be the original owner of the product and can supply proof of purchase.

Baja Designs manufactures its own products as well as resells products manufactured by others. Baja Designs makes no express or implied warranties on products not manufactured by Baja Designs including without limitation any warranties or merchantability and fitness for a purpose. We will, however, pass on all warranties made by the manufacturer, who has sole responsibility for performing such warranties.

Baja Designs will pay the freight if your product is less than 90 days old, otherwise defective products must be returned to Baja Designs, Inc., freight prepaid. At our option, we will repair or replace items in question and return them at no charge. If the identical product is no longer available, we will replace with a similar product of equal value. Baja Designs Inc. will not be responsible for any indirect or consequential damages in connection with defective merchandise.

Items purchased through a Baja Designs authorized dealer must be returned through the dealer. Only available on LED auxiliary lights and product must be in sellable condition at MSRP. Product that has been damaged in any way after the original purchase date will be excluded from this guarantee.

Indemnification:

Buyer hereby acknowledges off-roading, racing and driving at night are dangerous activities and that the products and/or supplies purchased from Baja Designs are used in an inherently dangerous activity that may endanger life and limb; and in no event shall the seller, or seller's heirs and assigns, be held liable for consequential damages, nor shall seller's liability on any claim for damages arising out of or connected with the sale, delivery, or use of purchased products and/or supplies exceed the purchase price of the products and/or sup

Toyota, Tacoma/4Runner S2 Reverse Kit Instructions

Tools Required

- 4mm and 6mm Allen wrench
- 12mm or 10mm Socket wrench
- 3/4" Drill or Stepped drill
- 13mm Allen wrench

***Note:** Extra hardware is included in case your vehicle was not equipped with a tow package and you need to bolt to a vacant hole. Alternatively, hardware can replace pre-existing plastic hardware to mount the lights.

1. Locate the existing bolt mounting locations shown by the arrows on the right for your vehicle year.
2. Remove the 12mm or 10mm hex head bolt on the underside of the bumper (Models vary). Mount the S2 bracket with the bolt. (If there is no bolt present, alternate hardware is included to use the existing hole.)
3. Attach the light to one side of the bracket using the 4mm Allen wrench to tighten the housing bolt into the light. Serrated washers will be used in between the bracket and the light. Then thread in the opposite side housing bolt. Repeat for the other light.

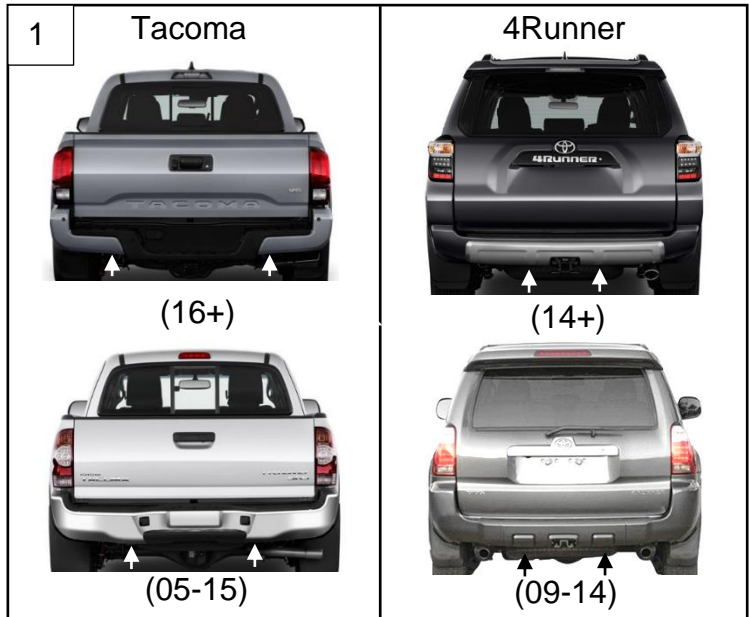

4. With the provided splitter harness, plug in the passenger side light and route the harness across to the driver side along the inside of the rear bumper. Route the open end of the splitter harness forward along the frame rail and OEM harness.
5. Attach the 10 ft extension harness to the splitter and continue forward along the driver side frame rail following the OEM harness. Open the hood and lower the light plug end of the main harness down in-between the driver side inner fender and the engine. Attach to the extension harness and pull the slack into the engine compartment.



6. Route the switch lead of the harness to the firewall passthrough grommet next to the brake booster. Take a photo of the wiring on the switch to reference later. Remove the switch terminals from the switch, pierce a small hole in the passthrough grommet, and route switch wires through. Drill a hole in a desired dash location where there is clearance behind. Then, reattach switch terminals and mount the switch.

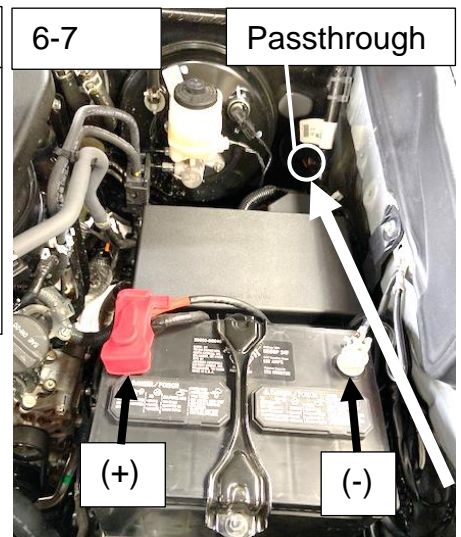
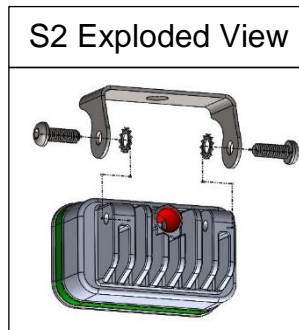

7. Attach positive ring terminal of the harness to the battery with the 10mm socket wrench. Then attach negative ring terminal. Tie the entire harness and relay away from all hot, sharp, and/or rotating components.

Re-torque all the fasteners after 100 miles.

Your install is now complete! Thank you for choosing Baja Designs.